



Glenmore Ashford Road, Bakewell, DE45 1GL



Glenmore Ashford Road

Guide Price

£400,000

£400,000 - £425,000 Guide Price

Situated on the edge of Bakewell, adjoining open countryside and enjoying attractive views, this charming two double bedroom detached bungalow offers a wonderful opportunity to enjoy a peaceful setting within easy reach of the town's excellent amenities. Available with no upward chain, the property retains a wealth of traditional character while providing light and airy accommodation throughout.

The welcoming side entrance lobby leads to a useful utility/store and a fitted kitchen with a pantry. An inner hallway with built-in storage gives access to a spacious sitting room, where a feature bay window fills the room with natural light, the front double bedroom enjoys a matching bay window. A dining room to the rear benefits from patio doors opening onto the delightful rear garden, offering flexibility to suit a variety of lifestyles. A further double bedroom and a bathroom.

Outside, the property is approached via a driveway providing off-road parking, with the added benefit of a detached workshop/garage and separate store to the rear. The attractive front garden creates an inviting first impression, while the substantial rear garden is a particular highlight, featuring well-stocked planted beds and borders, mature specimen shrubs and trees, providing a colourful and private outdoor space to enjoy throughout the seasons.

Perfectly positioned to take advantage of everything Bakewell has to offer, from its vibrant shops, cafés and restaurants to beautiful countryside walks on the doorstep, this delightful bungalow combines a sought-after location with spacious accommodation and exceptional gardens, making it an appealing home for a wide range of buyers.



- Beautiful Gardens Adjoining Farmland
- Ideally Located On The Edge Of Bakewell
- Close To An Excellent Range Of Shops Amenities
- Offers Scope To Enlarge (Subject To Gaining The Relevant Planning Consents)
- Attractive Views
- Off Road Parking & Garage/Workshop
- No Upward Chain
- EPC: TBC
- Viewings: Bakewell Office





Glenmore

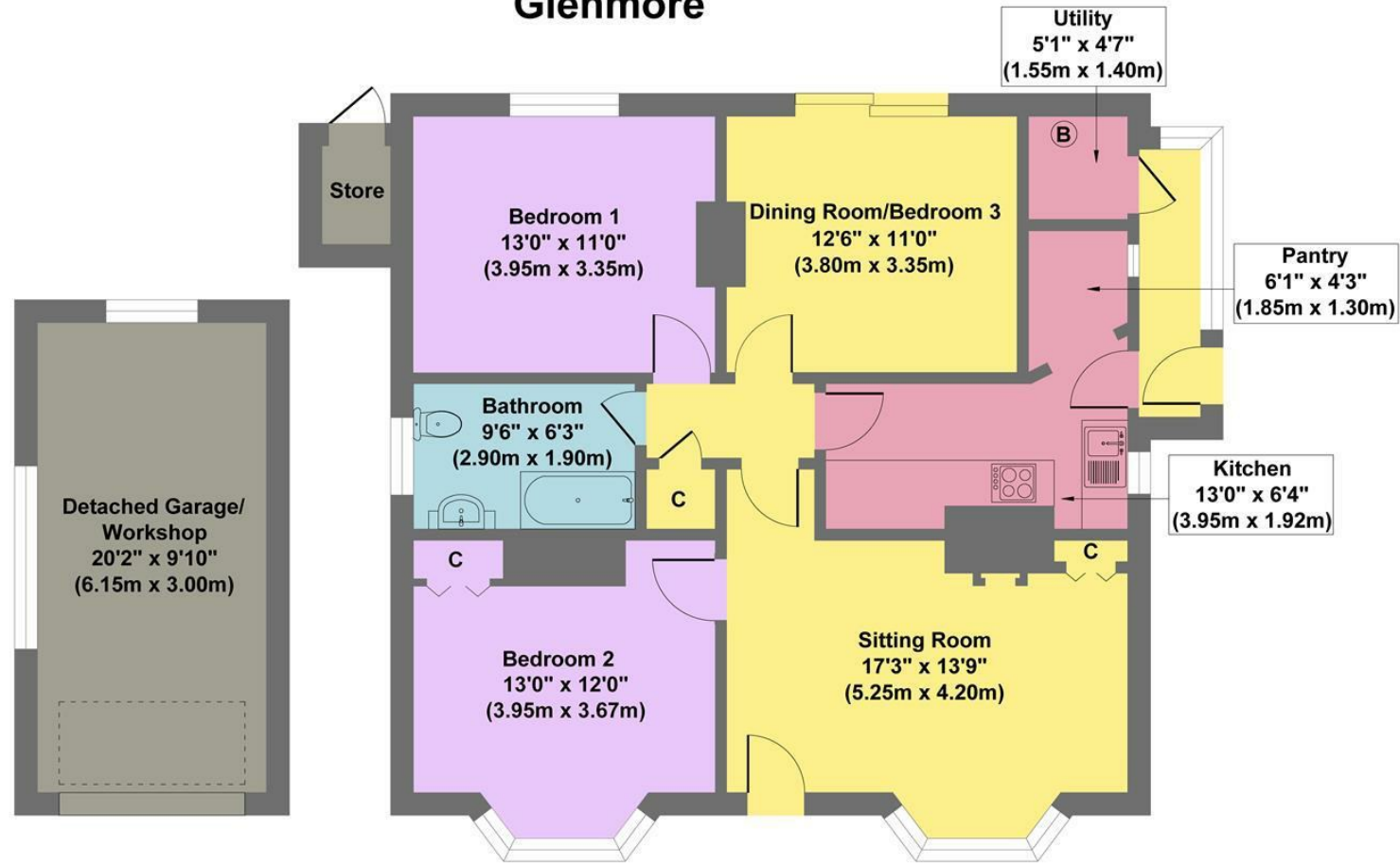

Garage
Approximate Floor Area
199 sq.ft
(18.45 sq.m.)

Approximate Floor Area
966 sq.ft
(89.71 sq.m.)

Approx. Gross Internal Floor Area 1165 sq.ft / 108.16 sq.m

Illustration for identification purposes only. Measurements are approximate, not to scale

While we endeavour to make our sales particulars fair, accurate and reliable, they are only a general guide to the property and, accordingly, if there is any point, which is of particular importance to you, please contact the relevant office. The Agents have not tested any apparatus, equipment, fittings or services and so cannot verify they are in working order. The buyer is advised to obtain verification. Please note all the measurement details are approximate and should not be relied upon as exact. All plans, floor plans and maps are for guidance purposes only and are not to scale. Under no circumstances should they be relied upon as exact or for use in planning carpets and other such fixtures, fittings or furnishings. YOUR HOME IS AT RISK IF YOU DO NOT KEEP UP REPAYMENTS ON A MORTGAGE OR OTHER LOAN SECURED ON IT. 'A Life Assurance policy may be requested.' 'Written Quotations of credit terms available on request.'

Banner Cross
 T: 0114 268 3241
 E: bannercross@saxtonmee.co.uk
www.saxtonmee.co.uk

Hathersage
 T: 01433 650009
 E: hathersage@saxtonmee.co.uk

Bakewell
 T: 01629 815307
 E: bakewell@saxtonmee.co.uk

Matlock
 T: 01629 828250
 E: matlock@saxtonmee.co.uk

